

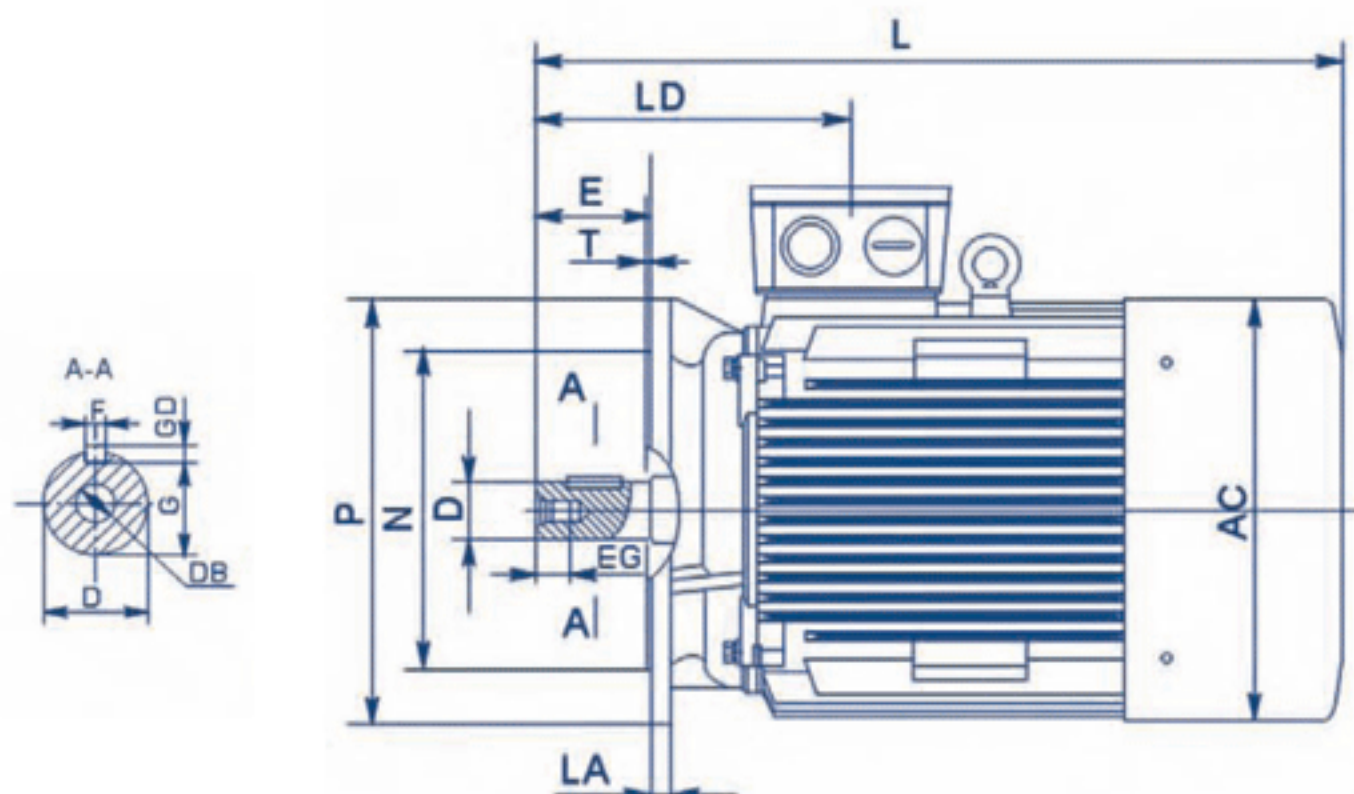

TAMANHO STANDARD Carcaça em ferro

132-280



132-200

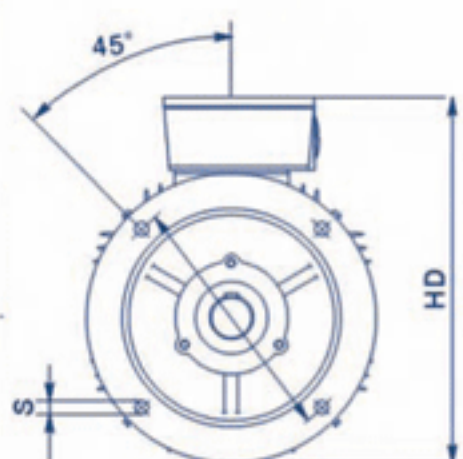

225-280

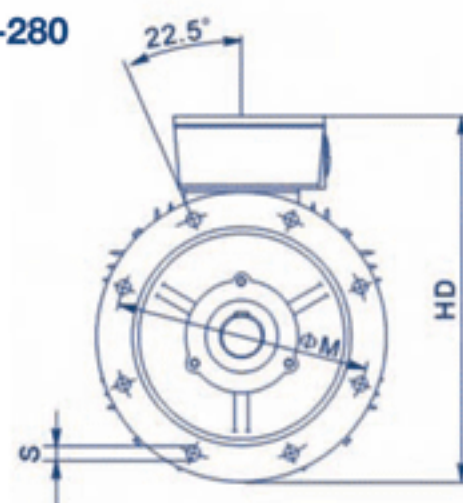

TIPO	D		E		F x GD		G		T	M	N	P	S	DBXEG	AC	HF	L	
	2P	4.6.8.P	2P	4.6.8.P	2P	4.6.8.P	2P	4.6.8.P									2P	4.6.8.P
132S.	38		80		10x8		33		4	265	230	300	15	12x28	275	345	470	
132M.	38		80		10x8		33		4	265	230	300	15	12x28	275	345	510	
160M.	42		110		12x8		37		5	300	230	350	19	16x36	330	420	615	
160L.	42		110		12x8		37		5	300	230	350	19	16x36	330	420	670	
180M.	48		110		14x9		42,5		5	300	230	350	19	16x36	380	455	700	
180L.	48		110		14x9		42,5		5	300	230	350	19	16x36	380	455	740	
200L.	55		110		16x10		49		5	350	300	400	19	20x39	420	505	770	
225S.	60		140		18x11		53		5	400	350	450	19	20x39	470	560	815	
225M.	55	60	110	140	16x10	18x11	49	53	5	400	350	450	19	20x39	470	560	820	845
250M.	60	65	140		18x11		53	58	5	500	450	550	19	20x39	515	625	930	
280S.	65	75	140		18x11	20x12	58	67,5	5	500	450	550	19	20x39	585	700	975	
280M.	65	75	140		18x11	20x12	58	67,5	5	500	450	550	19	20x39	585	700	1040	

